

3151 S White Road  
San Jose, California

# Evergreen Plaza Professional Center



## PROPERTY INFORMATION:

- Unit #201: 1,250± SF
- Fully Plumbed Dental Suite: 4 Operatories, 3 Open and 1 Private, plus X-Ray Room
- Spacious Lobby and Reception Area
- Central Vacuum and Compressed Air System
- Elevator Served
- Monument Signage
- Ample Parking
- Easily Accessible from Capitol Expressway and Hwy 101
- Base Rent: \$3.95 PSF, Modified Gross
- TI Allowance Available

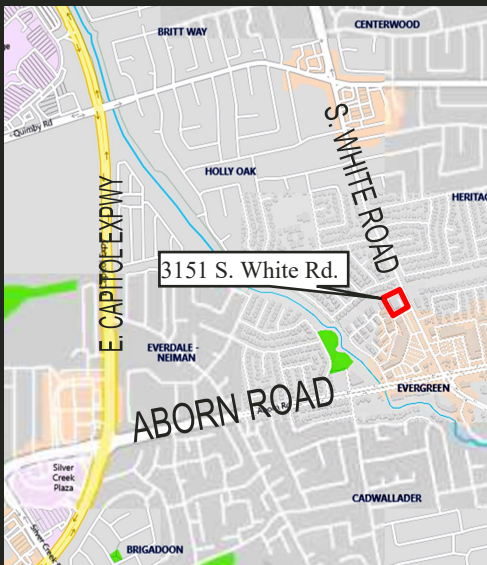

## ESTIMATED DEMOGRAPHICS:

	<u>1 MILE</u>	<u>3 MILES</u>	<u>5 MILES</u>
POPULATION:	30,562	187,418	445,852
AVG. HH INCOME:	\$179,224	\$166,405	\$144,417

## FOR MORE INFORMATION CONTACT:

**Ryan Warner**  
Lic. #01397580  
[rwarn@moinc.net](mailto:rwarn@moinc.net)  
(408) 378-5900



**COMMERCIAL BROKERAGE | INVESTMENT SALES | PROPERTY MANAGEMENT**

8 N. San Pedro Street, Suite 300 San Jose, California 95110  
Tel: 408.378.5900 [www.moinc.net](http://www.moinc.net)

**3151 South White Road • San Jose, California**

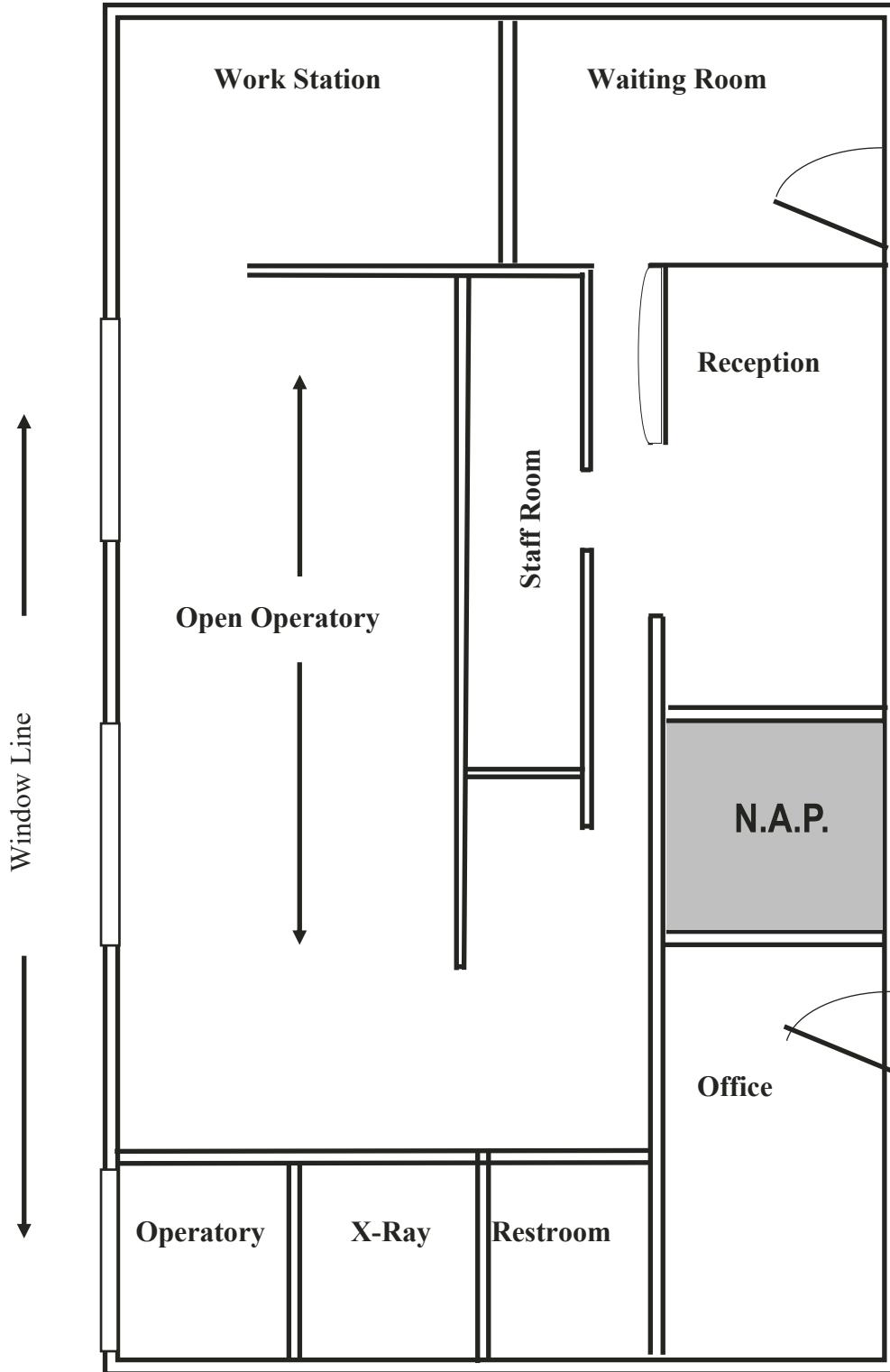

**NOT EXACT/NOT TO SCALE**

# 3151 South White Road • San Jose, California

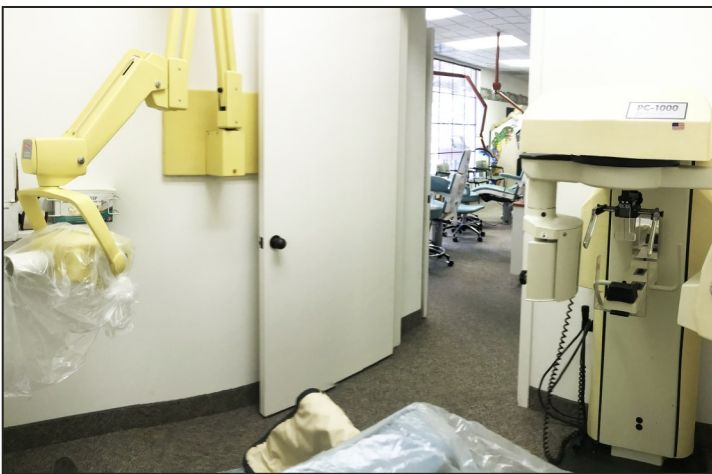
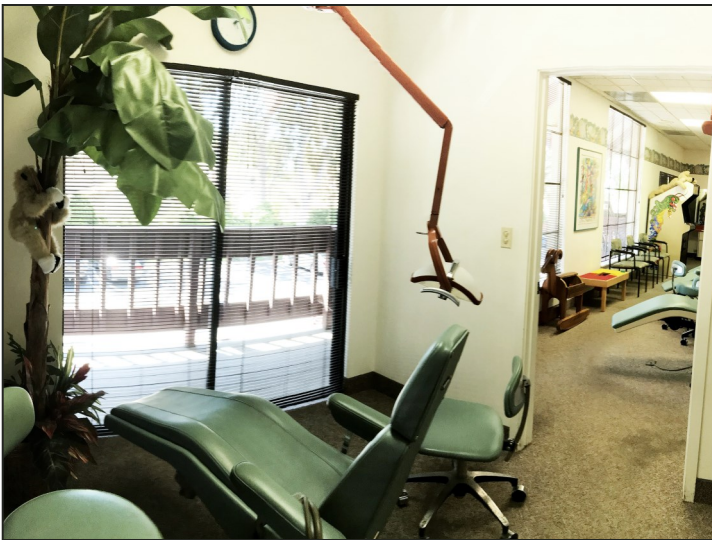

3151 South White Road • San Jose, California

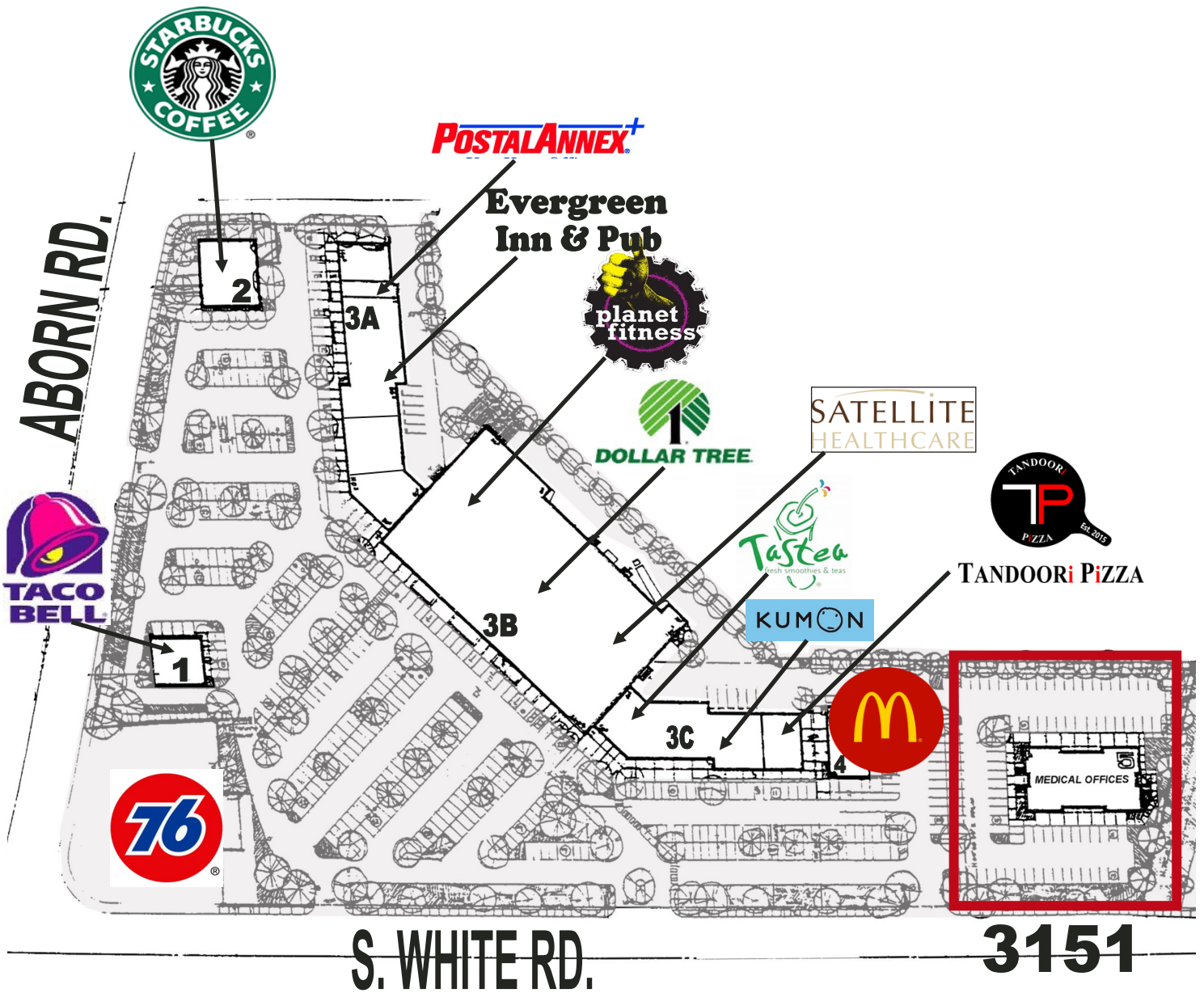

# 3151 South White Road • San Jose, California

