



studio
dmarc
www.dmarcstudio.com 415.226.9100

COMING SOON!!!

2887 SENTER ROAD, SAN JOSE



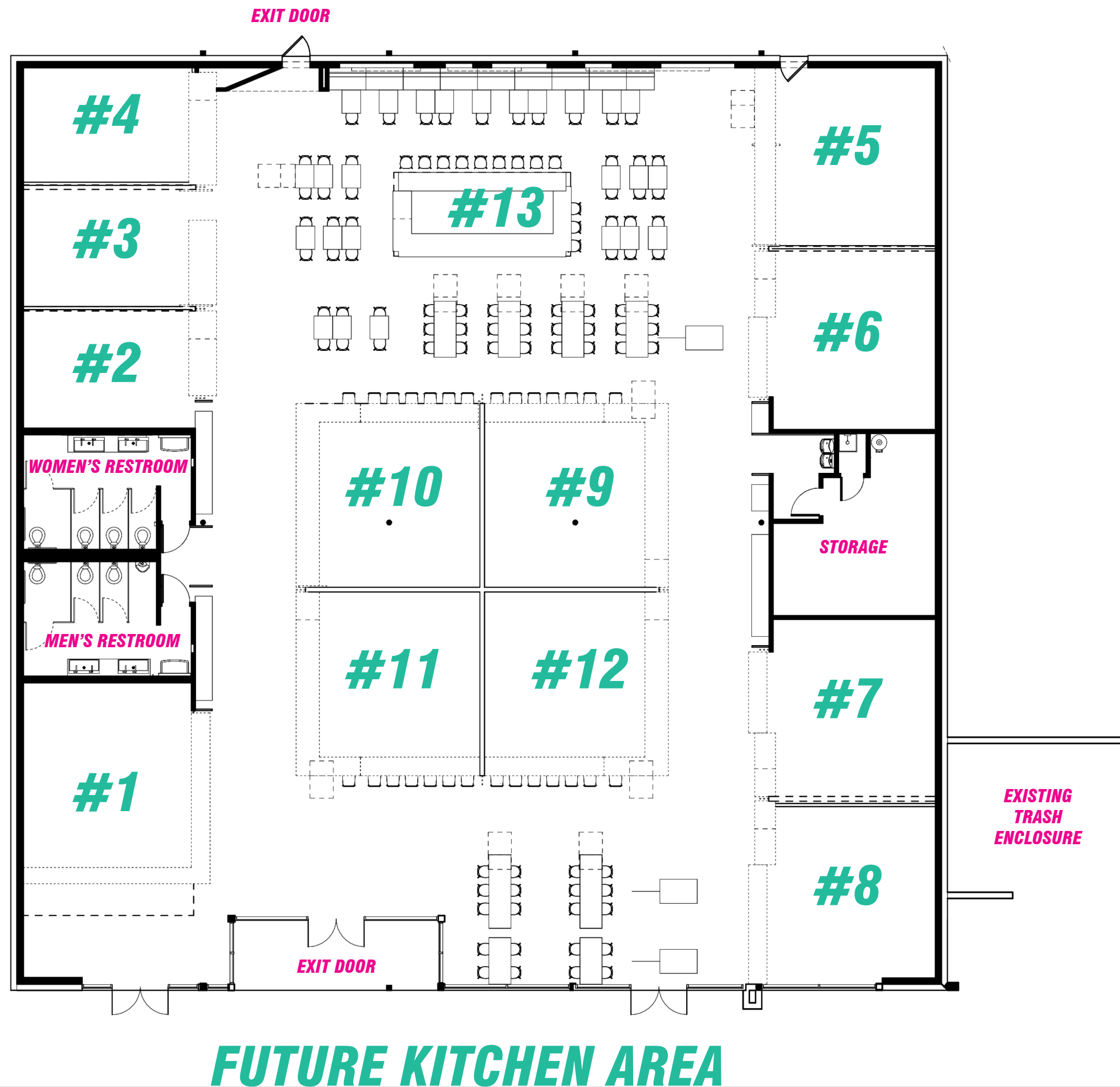

The information contained herein has been obtained from sources we deem reliable. We cannot, however, assume responsibility for its accuracy.

LAYOUT DIAGRAM



studio
dmarc
www.dmarcstudio.com TEL: 415.258.9100



The information contained herein has been obtained from sources we deem reliable. We cannot, however, assume responsibility for its accuracy.

SIGNAGE DENSITY/VARIETY

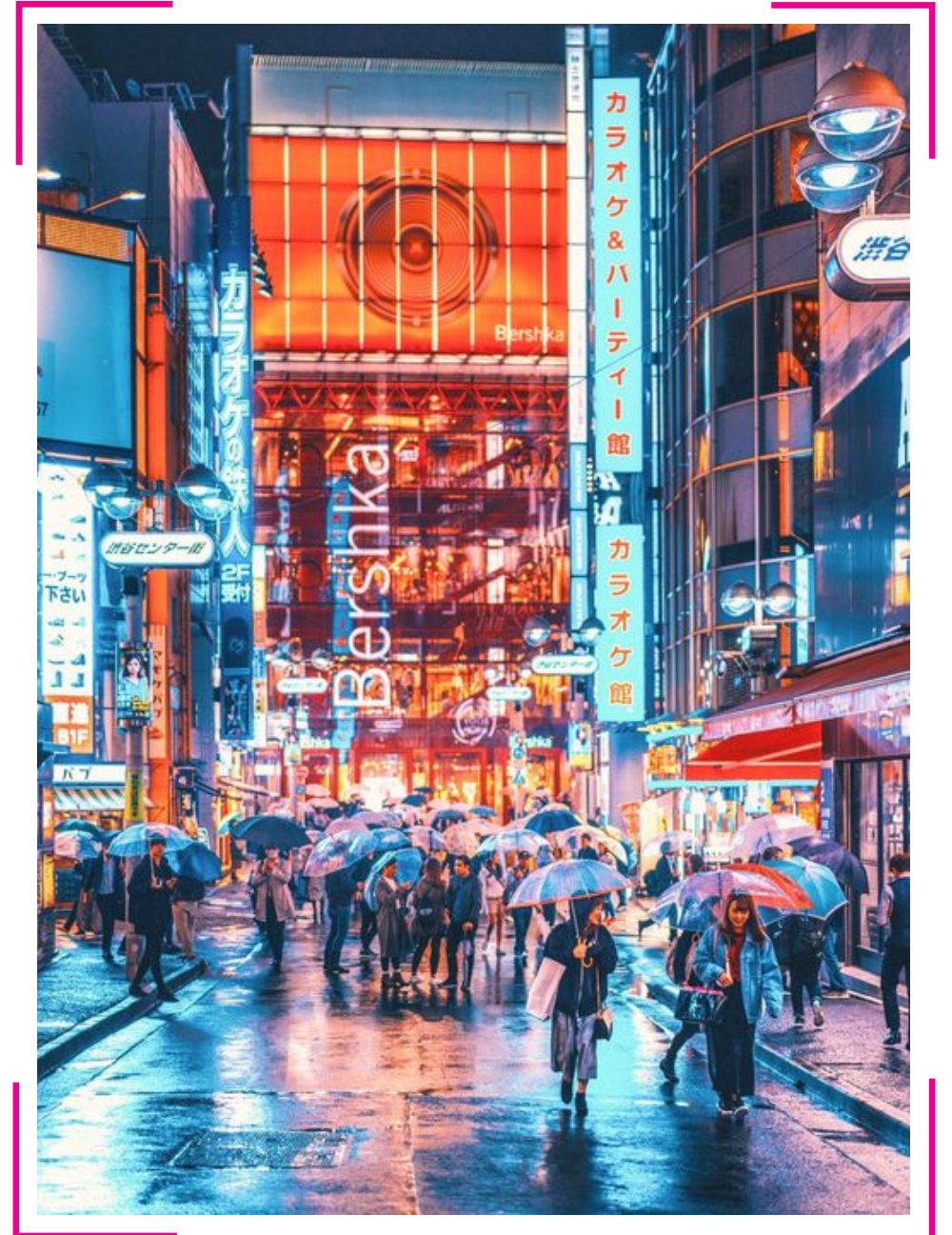
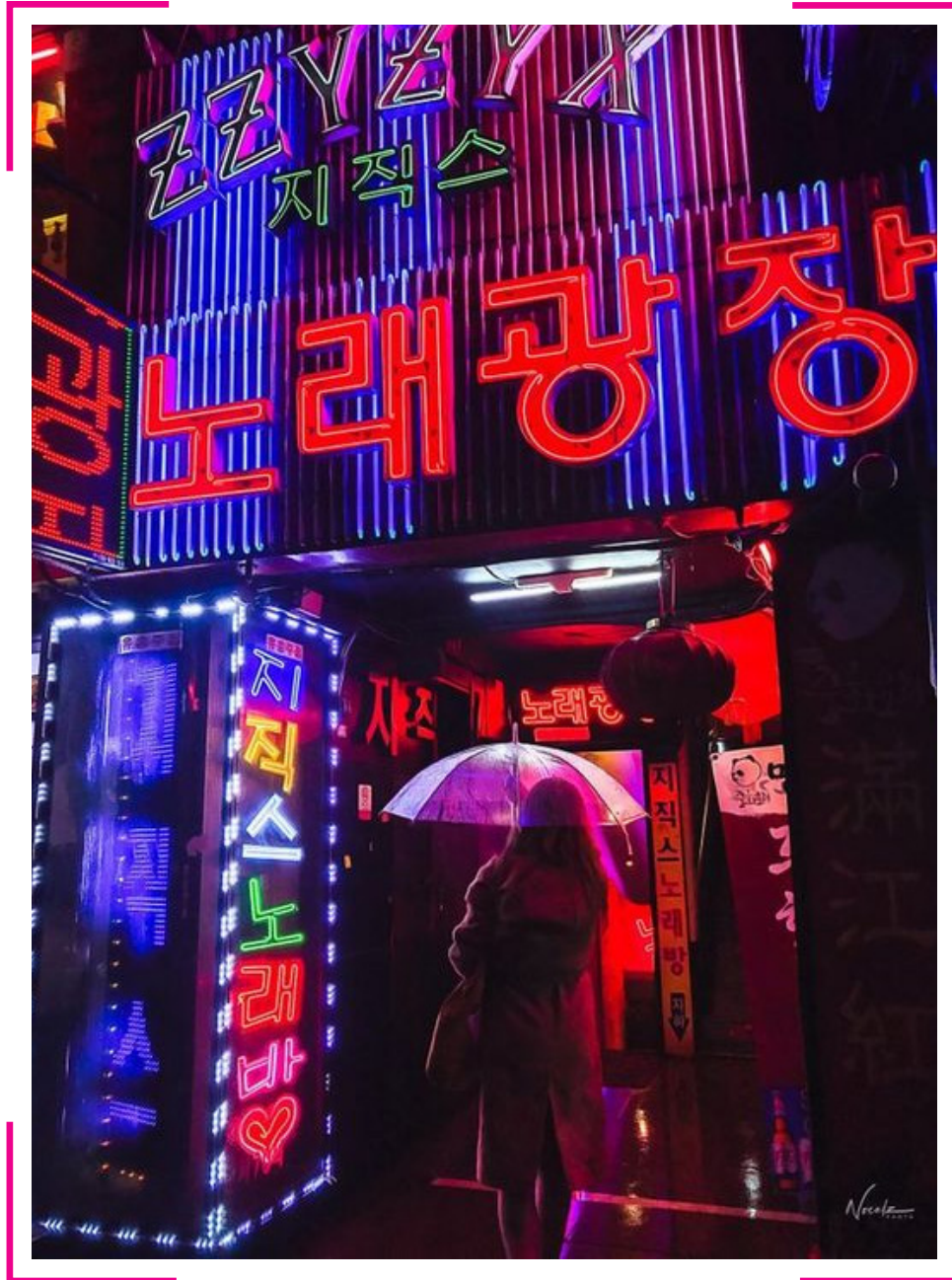

The information contained herein has been obtained from sources we deem reliable. We cannot, however, assume responsibility for its accuracy.

INTERIOR REFERENCES - SCIENCE FICTION



The information contained herein has been obtained from sources we deem reliable. We cannot, however, assume responsibility for its accuracy.

OVERHEAD SIGNS - CROWDED GROUND



The information contained herein has been obtained from sources we deem reliable. We cannot, however, assume responsibility for its accuracy.

ART FEATURES - VIETNAMESE LANTERNS

- East San Jose is home to many different cultures. Senter Food Court's goal is to establish a **trendy, tasty, and diverse** range of foods all under one roof.
- This **state-of-the-art** food court will modernize how many locals perceive restaurants. With over 13 different kiosks, Senter Food Court will be the first of its kind in East San Jose.
- The owner of the project has always envisioned making this shopping center a **central hub** for this part of San Jose. With the addition of Lee's Supermarket and the opening of Senter Food Court he has transformed the center completely.

SENER FOOD "NIGHT" MARKET

Available SF: 230 to 10,000 SF

Building Size: 10,000 SF

Asking Price: Approx. \$4,800 to \$5,800

Co-Anchor Tenant: Lee's Supermarket

The information contained herein has been obtained from sources we deem reliable. We cannot, however, assume responsibility for its accuracy.

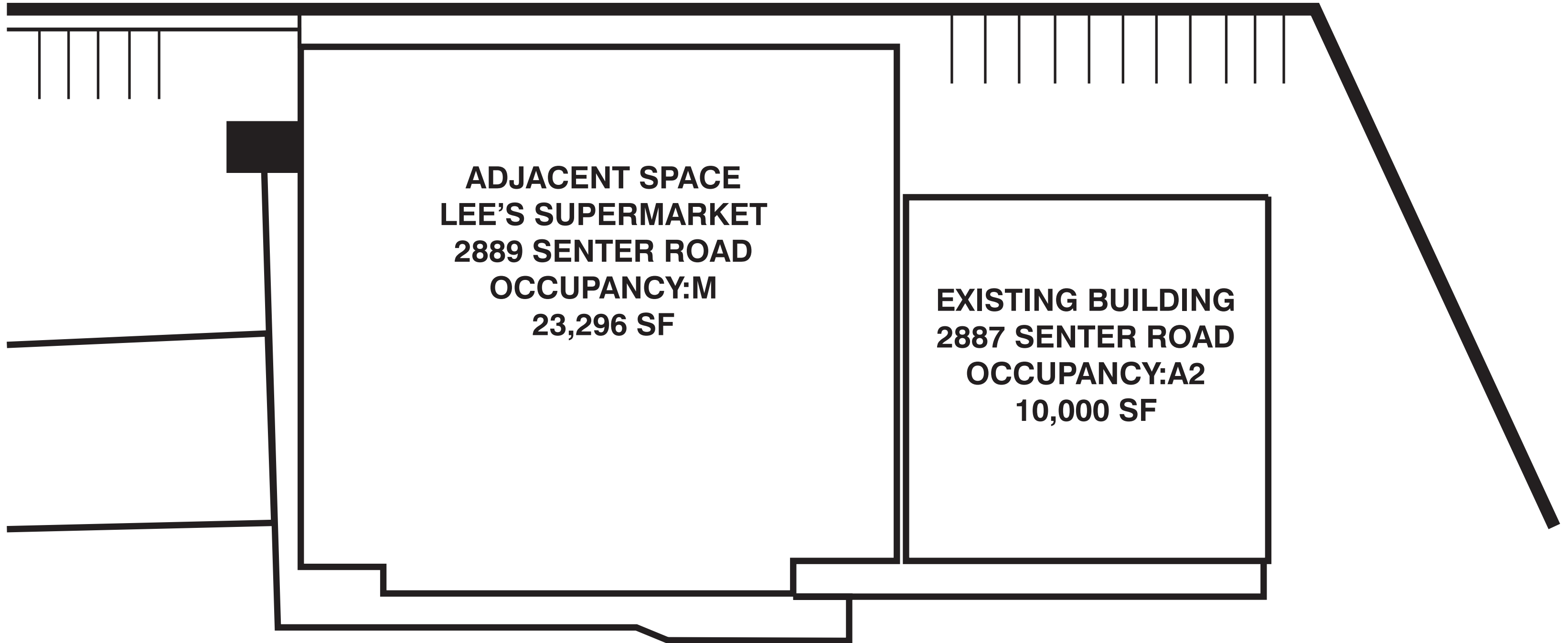

The information contained herein has been obtained from sources we deem reliable. We cannot, however, assume responsibility for its accuracy.

SITE PLAN

UMBARGER ROAD

SENER ROAD

**COYOTE CREEK
SAN JOSE**

2887 SENTER ROAD, SAN JOSE



LEWIS ROAD

E CAPITOL EXPY

The information contained herein has been obtained from sources we deem reliable. We cannot, however, assume responsibility for its accuracy.

MAP

2023 SUMMARY

1-MILE

3-MILE

5-MILE

POPULATION

30,920

248,952

658,790

HOUSEHOLDS

8,502

73,130

208,183

AVERAGE HOUSEHOLD SIZE

3.62

3.37

3.11

OWNER OCCUPIED HOUSING UNITS

5,412

41,443

112,423

RENTER OCCUPIED HOUSING UNITS

3,090

31,687

95,760

MEDIAN AGE

35.3

35.3

36.1

MEDIAN HOUSEHOLD INCOME

\$84,207

\$106,817

\$116,665

AVERAGE HOUSEHOLD INCOME

\$122,480

\$149,400

\$164,048

The information contained herein has been obtained from sources we deem reliable. We cannot, however, assume responsibility for its accuracy.

DEMOGRAPHICS

SEVENTH CENTER FOOD MARKET



COMING SOON!!!

studio
dmarc

www.dmarcstudio.com 161415.226.9100

The information contained herein has been obtained from sources we deem reliable. We cannot, however, assume responsibility for its accuracy.

DAVID TAXIN

Partner
+1 408 966 5919
dtaxin@moinc.net
Lic. 00983163

BOBBY FACCHINO

Associate
+1 408 318 0623
bobby@moinc.net
Lic. 02178873

MEACHAM/OPPENHEIMER, INC.
8 N San Pedro St #300
San Jose, CA 95110
www.moinc.net

