

# + 20,025 SF Retail Space For Lease

Across from Target, Home Depot, TJ Maxx HomeGoods, & 24-Hour Fitness

1832 Hillsdale Ave., San Jose

**Do Not Contact or Disturb Current Occupants**



**DAVID TAXIN**  
Partner  
+1 408 966 5919  
dtaxin@moinc.net

**JEREMY AWDISHO**  
Vice President  
+1 650 814 4510  
jeremy@moinc.net





## OVERVIEW



1832 Hillsdale Ave, San Jose

**Rental Rate:** \$2.35 SF NNN  
**Estimated NNNs:** \$0.55 PSF

**Unit Size:** ± 20,025 Square Feet

**ZONING:** CN – Commercial Neighborhood

**Available:** With 60-day notice

## HIGHLIGHTS

---

# 20,025+ SF Retail Space For Lease

- The space is currently occupied by Big Lots but can be made available with 60-day notice.
- Co-Tenants are S&G Carpet and Pump It Up!
- Directly across the street from a Power Center which includes national retailers such as **Target, Home Depot, TJ Maxx & HomeGoods, 24 Hour Fitness, McDonalds, & Starbucks.**
- Down the street from the new Cambrian Park Plaza redevelopment which includes retail, restaurants, a hotel, 305 apartments, 48 single family homes, 25 townhomes, and a senior living center.
- **Strategically positioned on the corner of Camden and Hillsdale Avenue** with excellent visibility and traffic counts as well as easy access to Hwy 85, 880, & 280.



The information contained herein has been obtained from sources we deem reliable. We cannot, however, assume responsibility for its accuracy.



PHOTO



The information contained herein has been obtained from sources we deem reliable. We cannot, however, assume responsibility for its accuracy.



PHOTO



The information contained herein has been obtained from sources we deem reliable. We cannot, however, assume responsibility for its accuracy.



# AERIAL



The information contained herein has been obtained from sources we deem reliable. We cannot, however, assume responsibility for its accuracy.



# AERIAL



The information contained herein has been obtained from sources we deem reliable. We cannot, however, assume responsibility for its accuracy.



# SITE PLAN

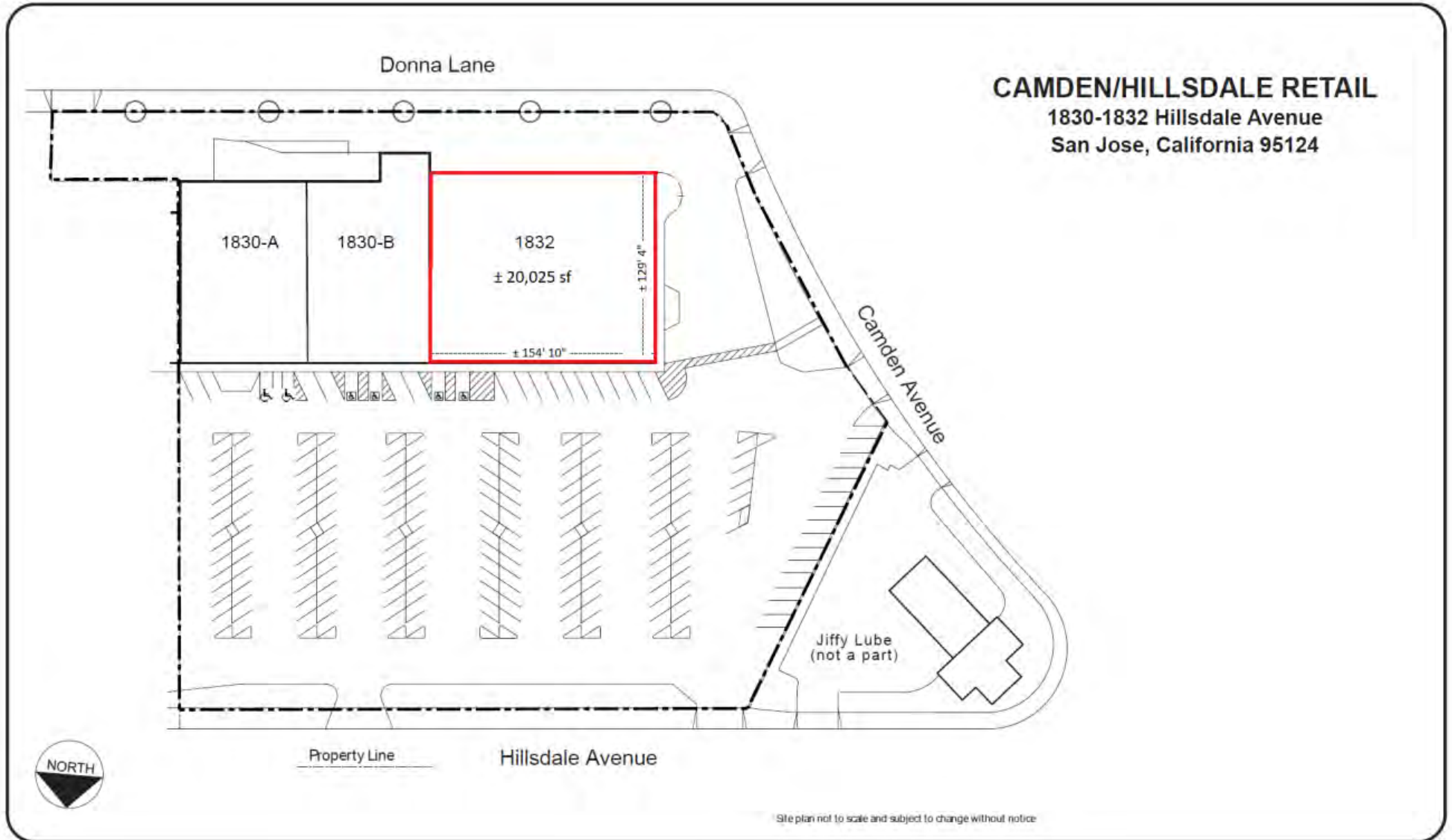



## DEMOGRAPHICS

---

<b>2022 SUMMARY</b>	<b>1-MILE</b>	<b>5-MILE</b>	<b>10-MILE</b>
<b>Population</b>	23,025	481,281	1,388,188
<b>Households</b>	8,066	177,357	464,126
<b>Average Household Size</b>	2.8	2.7	2.9
<b>Owner Occupied Housing Units</b>	5,989	98,279	258,868
<b>Renter Occupied Housing Units</b>	1,907	76,401	199,388
<b>Median Age</b>	40.3	39.3	38.3
<b>Median Household Income</b>	\$160,808	\$126,829	\$129,403
<b>Average Household Income</b>	\$179,217	\$158,641	\$158,790





1832 Hillsdale Ave.,  
San Jose

**DAVID TAXIN**  
Partner  
+1 408 966 5919  
dtaxin@moinc.net  
Lic. 00983163

**JEREMY AWDISHO**  
Vice President  
+1 650 814 4510  
jeremy@moinc.net  
Lic. 02064232

Meacham/Oppenheimer, Inc.  
8 N San Pedro St. #300  
San Jose, CA 95110  
Tel. 408-378-5900  
www.moinc.net

